

REALIZZAZIONE NUOVA PAVIMENTAZIONE DELLE PIAZZE DON BOSCO E SAN CRISTOFORO CON RELATIVE VIE DI COLLEGAMENTO  
 SEGNALETICA STRADALE TEMPORANEA DI CANTIERE - TAVOLA 3

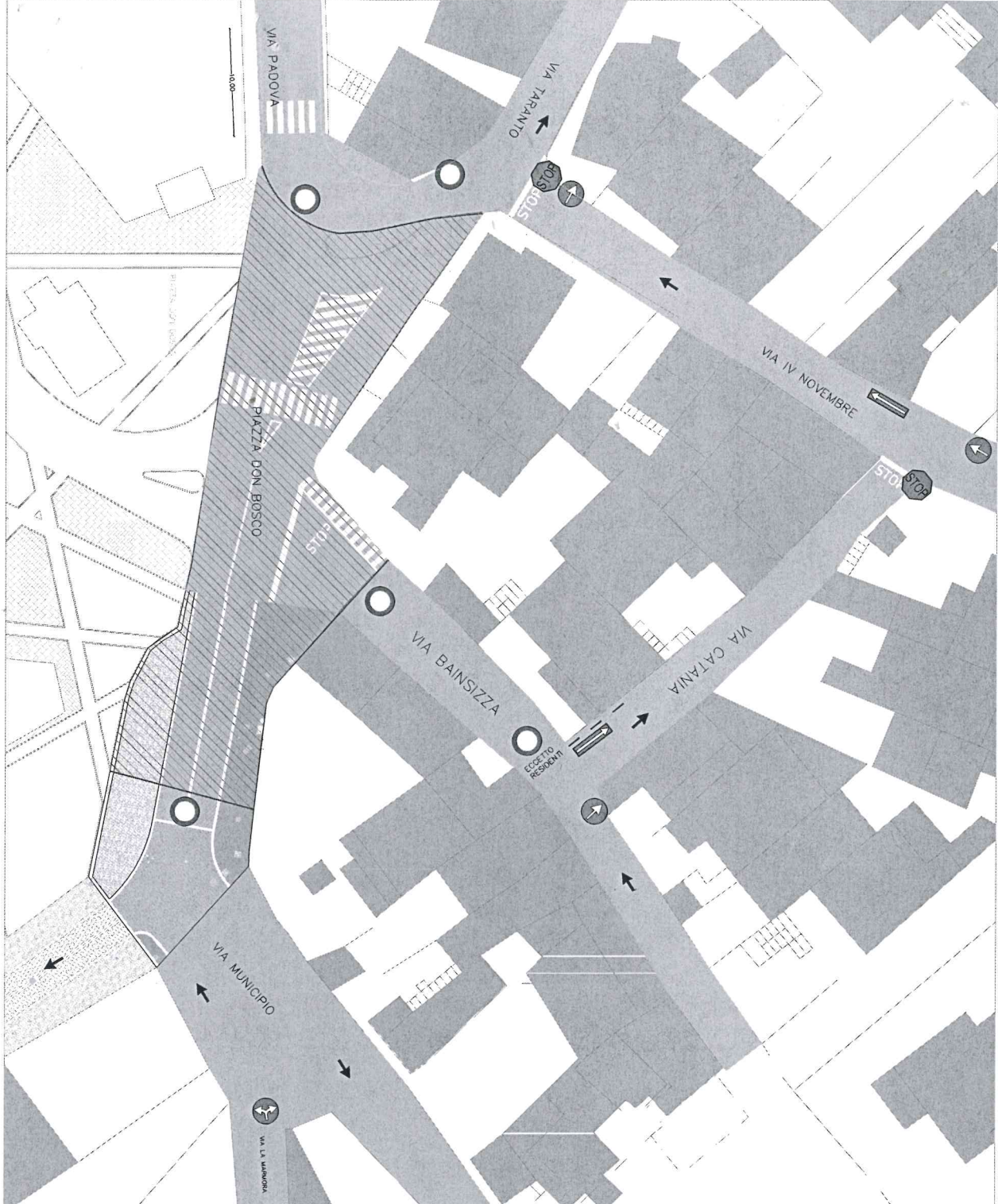

CHIUSURA SECONDO LOTTO DI LAVORI

NUOVA SEGNALETICA ORIZZONTALE TEMPORANEA - GIALLO



PLANIMETRIA SCALA 1:200

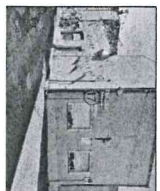
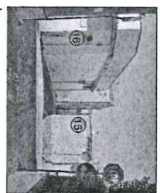

138 VIA CATANIA

0,60

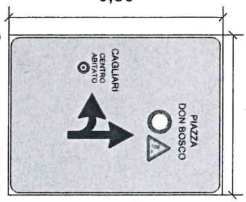

135 VIA GARIBALDI

0,80

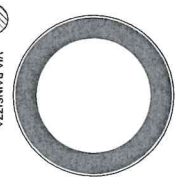

134 VIA BAINSIZZA

0,60

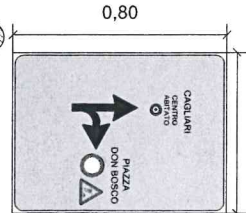

136 VIA TRIESTE - VIA BAINSIZZA  
 137 VIA TRIESTE - VIA IV NOVEMBRE

0,80

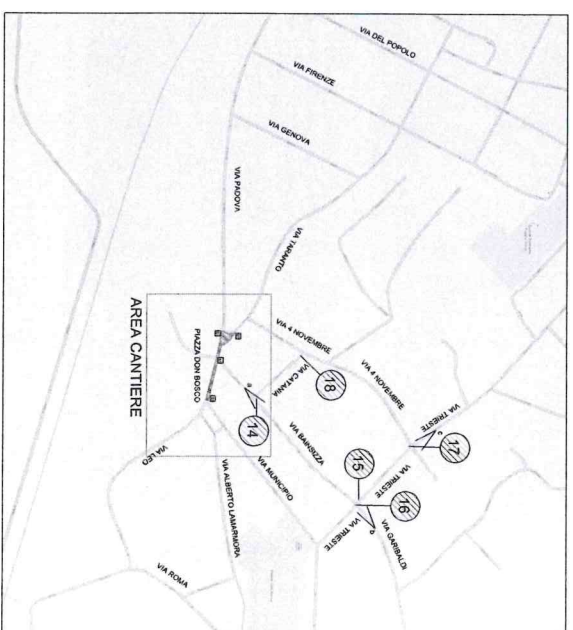

PLANIMETRIA DI INSIEME